

Dow Realty, Inc. Presents:

Lincoln-Way Area Farmland

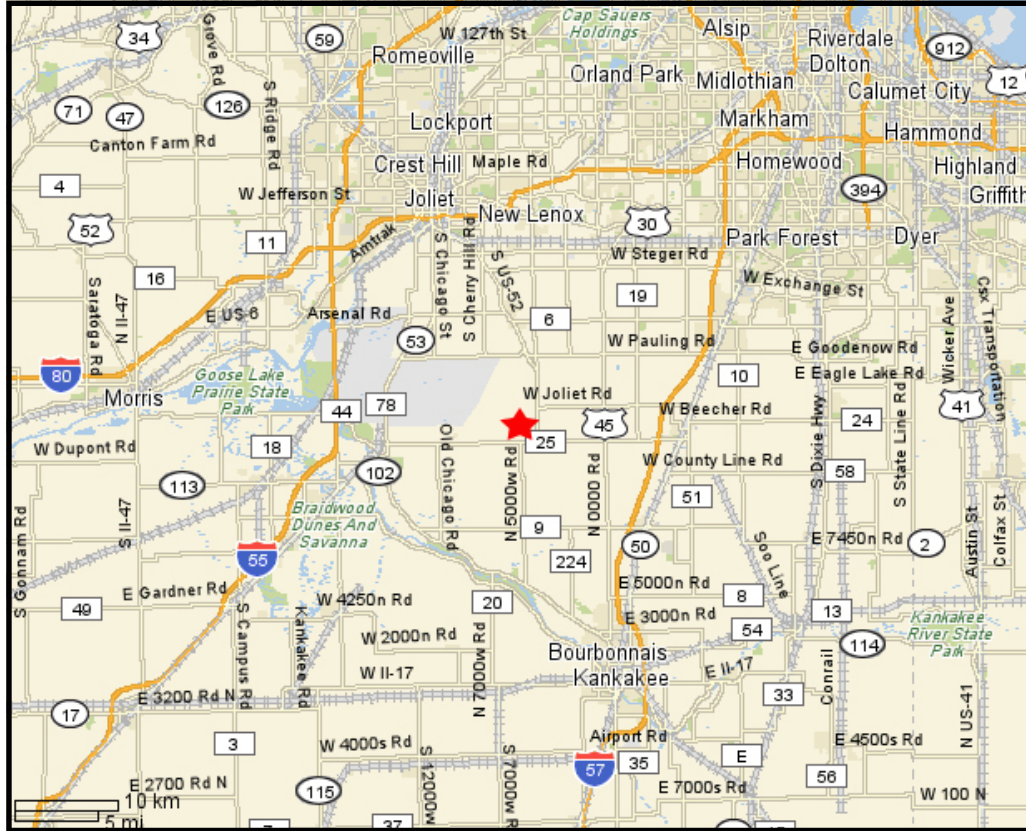

238.02 ACRES

- **3 parcels**
- **Mostly rolling land**
- **Currently zoned for agriculture**
- **Located in Will County, one of the nation's 100 fastest growing counties, between Manhattan & Peotone in Wilton Township**
- **Good infrastructure of roads and government services**
- **Peotone schools**

South Farm



Parcel 1: PIN # 13-19-21-100-005-0000 Wilton Township
Approx. Dimensions: 1282x2588x1280x742x324x239x333x1604 78.02 Acres

Parcel 2: PIN # 13-19-20-200-003-0000 Wilton Township
Approx. Dimensions: 2605x1296x2612x1296 80 acres

Parcel 3: PIN # 13-19-20-400-003-0000 Wilton Township
Approx. Dimensions: 1286x2615x1278x2606 80 Acres

Three parcels totaling 238.02 acres.

160 acres (2 parcels) in the
southeast corner of Section 20 in
Wilton Township.

78.02 acres (1 parcel) in the
northwest corner of Section 21 in
Wilton Township.

Parcels 1 & 2 listed at \$14,500/acre.

Parcel 3 listed at \$12,875/acre

Call for more details.

**Close to new
Manhattan Metra Station
and Peotone Airport!**



Dow Realty, Inc.

Tom Mulvey, CRB, CRS, GRI
Broker-Owner

1600 Plainfield Road, Joliet, IL 60435

Phone: 815-730-1900, ext. 22

Fax: 815-730-9614

E-mail: tmulvey@dowcompanies.com